



邮箱 E-mail: yangjg@whshoujia.com

whrt01@163.com

联系电话 Tel: +86 13100701526

邮编 P.C: 430013

地址 Add: 湖北省武汉市蔡甸区常福工业园西牛二街11号

(No. 11, Xiniu 2nd Street, Changfu Industrial Park,

Caidian District, Wuhan City, Hubei Province)

武汉首甲实业发展有限公司

Wuhan Shoujia Industrial Development Co., Ltd

WUHAN SHOUJIA INDUSTRIAL DEVELOPMENT

首信以诚 甲冠天下

The First Faith With Sincerity Crown The World

目录
DIRECTORY

01 企业简介 —— 01-12
Company Profile

02 企业产品 —— 13-23
Company product

03 技术实力 —— 24-36
Technical strength

04 我们的优势 —— 37-38
Our Advantages

企业简介 Company Profile

首甲集团成立于2002年，至今已在汽车市场上拼搏奋斗二十余年。我们凭借着中国汽车工业蓬勃发展的东风扶摇而上，从初期坐落于十堰市的一家公司壮大成为遍布全国各地、由诸多大型工厂组成的庞大团队。如今，我们拥有超过600亩的首甲工业园，为国内主要整车和零部件主机厂供应一千多种产品，年产值超过五亿元。

作为一家伴随中国汽车工业壮大的零部件制造企业，我们秉承“客户至上、质量第一、技术领先、合作共赢”的理念，这不仅是我们的企业信念，更是我们坚持的追求。因此，我们汇聚机械、汽车等技术方面的500多名精英来打磨产品、服务客户，同时不断扩大生产基地，从十堰市扩张至武汉、天津、西安、保定、成都等地区，形成了强大的生产能力，不断拓宽业务覆盖范围。

我们目前在国内的产品范围覆盖汽车行业三大产品系列：冲压件及焊接总成件系列、制管及管梁总成系列以及汽车钣金类模检夹具系列。其中，冲压件模块年生产8000万件，管梁总成系列年生产管件6000吨、管梁总成20万件，为各大整车和主机厂提供高质量的零部件。

如果首甲能够有幸成为贵公司的合作伙伴，我们将以细致周到的服务和精湛的工艺水平让您满意。我们期待您的光临和指导！

Shoujia Group was established in 2002 and has been struggling in the automotive market for more than 20 years. We have taken advantage of the booming development of China's automotive industry and grown from a company located in Shiyan City to a large team consisting of many large factories scattered throughout the country. Nowadays, we have over 600 acres of Shoujia Industrial Park, supplying more than 1000 types of products to major domestic vehicle and component manufacturers, with an annual output value of over 500 million yuan.

As a component manufacturing enterprise that accompanies the growth of China's automotive industry, we adhere to the concept of "customer first, quality first, technological leadership, and win-win cooperation". This is not only our corporate belief, but also our pursuit. Therefore, we have gathered more than 500 elites in mechanical, automotive and other technical fields to polish products and serve customers, while continuously expanding our production base from Shiyan City to Wuhan, Tianjin, Xi'an, Baoding, Chengdu and other regions, forming a strong production capacity and expanding our business coverage.

Our current product range in China covers three major product series in the automotive industry: stamping and welding assembly series, pipe and beam assembly series, and automotive sheet metal inspection fixture series. Among them, the stamping module produces 80 million pieces annually, the pipe beam assembly series produces 6000 tons of pipe fittings and 200000 pieces of pipe beam assemblies annually, providing high-quality components for major vehicle and host factories.

If Shoujia is fortunate enough to become a partner of your company, we will satisfy you with meticulous and thoughtful service and exquisite craftsmanship. We look forward to your visit and guidance!

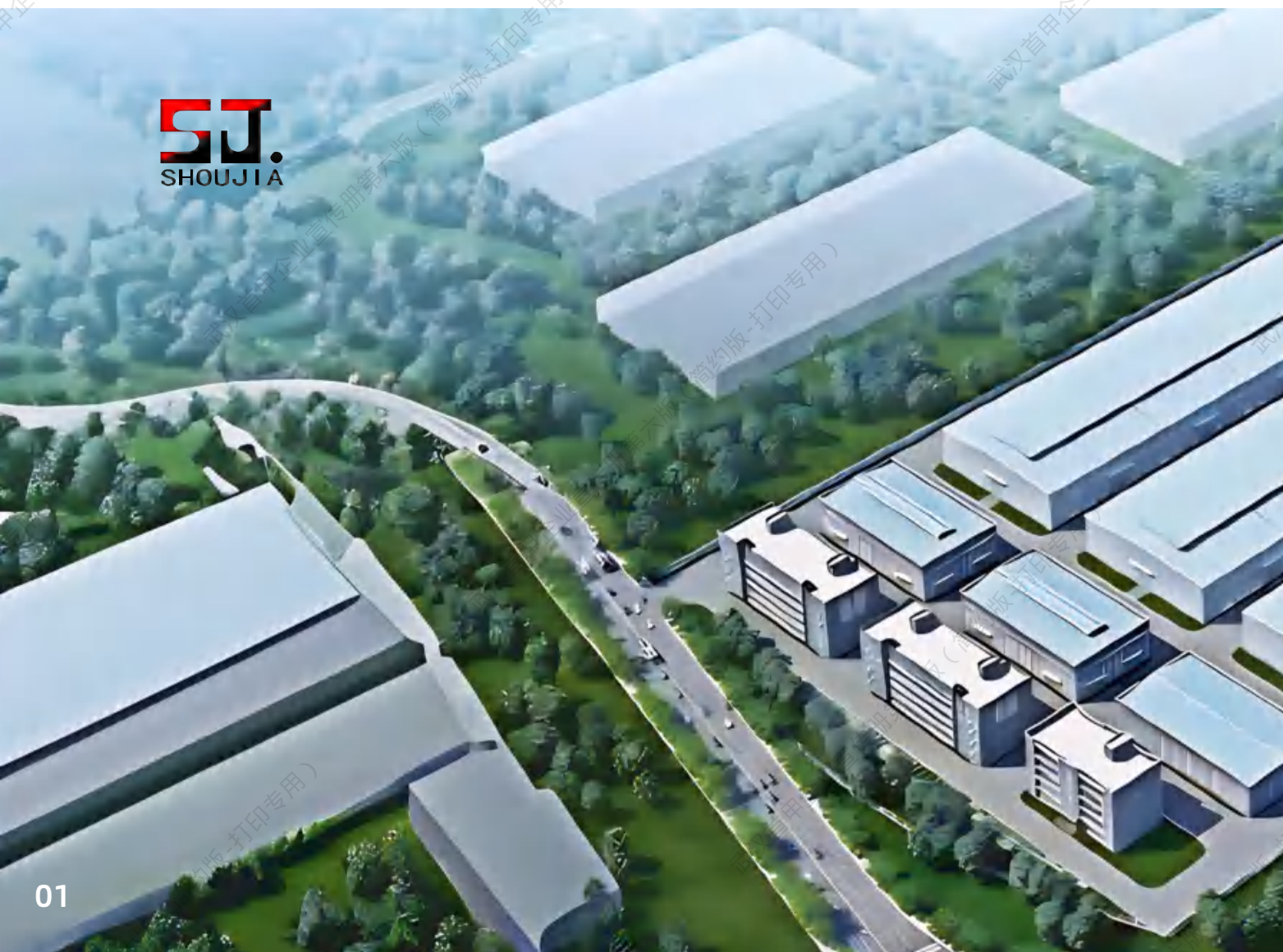

企业历程 Company History

■ 2002

十堰公司及工厂成立，占地面积150亩，主营汽车零部件制造。

Shiyan Company and its factory were established, covering an area of 150 acres, mainly engaged in the manufacturing of automotive parts.

■ 2012

武汉首甲实业发展有限公司及天津工厂成立，占地面积达260亩，武汉本部人员增加至200余人。

Wuhan Shoujia Industrial Development Co., Ltd. and Tianjin factory were established, covering an area of 260 acres. The personnel of Wuhan headquarters increased to more than 200 people.

■ 2016

成都工厂成立，占地面积为百余亩，人员规模增至百人。

Chengdu factory was established, covering an area of over 100 acres and with a staff size of 100 people.

■ 2018

保定工厂成立，冲压件及焊接总成件系列、制管及管梁总成系列蓬勃发展。

The Baoding factory was established, and the series of stamped and welded assemblies, as well as the series of pipe and beam assemblies, flourished.

■ 2019

西安工厂成立，集团总员工人数达五百人，总占地面积超过600亩。

Xi'an Factory was established, with a total of 500 employees and a total area of over 600 acres.



合作品牌 Cooperative Brands

经过二十余年的打拼发展，首甲集团积累了大量合作伙伴，包括比亚迪汽车、长城汽车、吉利汽车、东风集团及上汽集团等知名企业，凭借自身过硬的技术实力与和各大汽车企业展开深度合作，为其生产大量汽车冲压件及管梁总成件，获得客户一致好评。

After more than 20 years of hard work and development, Shoujia Group has accumulated a large number of partners, including well-known enterprises such as BYD Auto, Great Wall, GEELY AUTO, Dongfeng Group, and SAIC Motor Corporation Limited. With its strong technical strength, Shoujia Group has engaged in deep cooperation with major automotive enterprises, producing a large number of automotive stamping parts and pipe beam assemblies for it, and has received unanimous praise from customers.



■ 质量体系 Quality system

首甲集团拥有完备的质量管理体系，通过了NSF-ISR品质运营国际认证，严格把控零部件从进货到出货的每一个环节，同时定期对生产设备进行试验和校正，并达到了IATF16949质量品质，用强力的质量管控体系增添新老客户的信任度。

Shoujia Group has a complete quality management system, passed the NSF-ISR quality operation international certification, strictly control every link of parts from purchase to shipment, while regularly testing and calibration of production equipment, and reached IATF16949 quality quality, with a strong quality control system to increase the trust of new and old customers.



企业文化 Corporate Culture

■ 文化理念 Cultural concepts



在我们汽车零部件制造企业的核心文化中，客户始终是我们最珍视的伙伴。我们坚信，客户的满意和信赖是我们发展的源动力。我们始终以客户需求为导向，从产品设计到生产流程，从售前咨询到售后服务，都致力于为客户提供最优质、最贴心的服务。我们倾听客户的声音，理解客户的期望，用我们的专业知识和技能，为客户创造超越期望的价值。

In the core culture of our automotive parts manufacturing enterprise, customers are always our most cherished partners. We firmly believe that customer satisfaction and trust are the driving force for our development. We always take customer needs as our guide, from product design to production process, from pre-sales consultation to after-sales service, we are committed to providing customers with the highest quality and most considerate service. We listen to the voices of our customers, understand their expectations, and use our professional knowledge and skills to create value beyond their expectations.



质量是我们企业的生命线，也是我们赢得客户信任的关键。我们坚持质量第一的原则，从原材料采购到生产过程的每一个环节，都严格把控质量，确保每一件产品都符合最高的质量标准。我们注重细节，追求卓越，致力于为客户提供最可靠、最耐用的汽车零部件产品。我们深知，只有质量过硬，才能赢得客户的长期信赖和合作。

Quality is the lifeline of our enterprise and the key to winning customer trust. We adhere to the principle of quality first, strictly controlling quality at every stage from raw material procurement to production, ensuring that every product meets the highest quality standards. We focus on details, pursue excellence, and are committed to providing customers with the most reliable and durable automotive component products. We deeply understand that only with excellent quality can we win the long-term trust and cooperation of our customers.



在竞争激烈的汽车零部件制造行业，技术领先是我们保持竞争优势的关键。我们注重技术创新和研发，不断引进先进的制造技术和管理理念，推动企业在技术和产品方面的升级换代。我们鼓励员工勇于探索、敢于创新，为企业的发展贡献智慧和力量。我们相信，只有技术领先，才能确保我们的产品始终走在行业的前列。

In the fiercely competitive automotive parts manufacturing industry, technological leadership is the key to maintaining our competitive advantage. We focus on technological innovation and research and development, continuously introducing advanced manufacturing technologies and management concepts, and promoting the upgrading and replacement of enterprises in terms of technology and products. We encourage employees to have the courage to explore and innovate, and contribute wisdom and strength to the development of the enterprise. We believe that only by leading technology can we ensure that our products always stay at the forefront of the industry.



合作是实现共赢的重要途径。我们注重与供应商、客户、合作伙伴之间的紧密合作，共同分享资源、知识和经验，实现互利共赢。我们尊重每一个合作伙伴，倾听他们的声音和需求，用我们的专业知识和技能为他们提供最有价值的支持。我们相信，只有合作共赢，才能推动整个行业的繁荣和发展。同时，我们也注重内部员工的团结协作，鼓励员工之间互相学习、互相帮助，共同为企业的发展贡献力量。

Cooperation is an important way to achieve win-win outcomes. We focus on close cooperation with suppliers, customers, and partners, sharing resources, knowledge, and experience together to achieve mutual benefit and win-win results. We respect every partner, listen to their voices and needs, and provide them with the most valuable support with our professional knowledge and skills. We believe that only through win-win cooperation can we promote the prosperity and development of the entire industry. At the same time, we also pay attention to the unity and cooperation of internal employees, encourage them to learn from and help each other, and jointly contribute to the development of the enterprise.



■ 组织架构 Organizational Structure



工厂分布 Factory Distribution

首甲集团的前身位于湖北省十堰市，命名为十堰日泰太阳星工贸有限公司，主要生产汽车配件等产品。随着生产规模的逐步扩大、公司人员不断增加，集团于2005年购买150亩工业用地。2011年，公司规模进一步扩大，武汉首甲实业发展有限公司正式成立，公司的主营业务也由生产汽车配件扩张至机床设备、大型冲压设备及特种设备制造。2012年，武汉工厂建立。与此同时，公司也将生产视野拓宽至湖北省外，基于与大型汽车企业的合作，将工厂建立至天津，又在随后的十年间一鼓作气，将工厂拓宽至四川成都（2016）、河北保定（2018）及陕西西安（2019）。公司具备敏锐的商业嗅觉，收购了长岗模具厂作为自己的子公司，同时也将业务版图拓宽至上海、湖南湘潭和天津等地。



The predecessor of Shoujia Group is located in Shiyan City, Hubei Province, named Shiyan Ritai Sun Star Industry and Trade Co., Ltd., mainly producing automotive parts and other products. With the gradual expansion of production scale and the continuous increase of company personnel, the group purchased 150 acres of industrial land in 2005. In 2011, the company further expanded its scale and Wuhan Shoujia Industrial Development Co., Ltd. was officially established. The company's main business expanded from producing automotive parts to manufacturing machine tools, large-scale stamping equipment, and special equipment. In 2012, the Wuhan factory was established. At the same time, the company has also expanded its production vision to outside Hubei Province. Based on cooperation with large automotive enterprises, the factory was established in Tianjin, and in the following decade, it worked hard to expand the factory to Chengdu, Sichuan (2016), Baoding, Hebei (2018), and Xi'an, Shaanxi (2019). The company has a keen business acumen and has acquired Changgang Mold Factory as its subsidiary, while also expanding its business scope to Shanghai, Xiangtan, Hunan, and Tianjin.



首甲模具厂

Shoujia Mould Factory

深圳长岗模具有限公司成立于2006年，专营汽车模具设计和制作，与市面上各个大型汽车公司拥有密切的技术往来。2018年，首甲集团将其纳入麾下，成为武汉首甲庭矩科技有限公司。

武汉首甲庭矩科技有限公司拥有一支强有力的设计团队。我们使用业界先进的工程软件如DYNAFORM,AUTOFORM对产品进行CAE分析、运用UG, VISI, Solid Works和CATIA等软件进行模具设计。设计团队稳定，拥有多年的经验积累，可以为客户全方位分析和解决产品问题，以确保模具品质要求。

作为一个拥有多台大型CNC数控机床、磨床、钻床等加工设备及630T、500T冲床等大型冲压试模设备的公司，长岗模具集团在深耕汽车零件冲压的同时也兼具新能源电池壳模具的开发与制作，作为首甲集团的子公司，它带领整个团队走在了技术的前列。



Shenzhen Changgang Mold Co., Ltd. was established in 2006, specializing in the design and production of automotive molds, and has close technical exchanges with various large automotive companies on the market. In 2018, Shoujia Group incorporated it under its umbrella, become Wuhan Shoujia Tingju Technology Co., Ltd.

Wuhan Shoujia Tingju Technology Co., Ltd. has a strong design team. We use advanced engineering software in the industry such as DYNAFORM and AUTOFORM for CAE analysis of products, and use software such as UG, VISI, Solid Works, and CATIA for mold design. The design team is stable and has accumulated many years of experience, which can provide customers with comprehensive analysis and solution of product problems to ensure the quality requirements of the mold.

As a company with multiple large CNC machine tools, grinding machines, drilling machines and other processing equipment, as well as large stamping and mold testing equipment such as 630T and 500T punching machines, Wuhan Shoujia Tingju Technology Co., Ltd. not only focuses on automotive parts stamping, but also develops and manufactures new energy battery shell molds. As a subsidiary of Shoujia Group, it leads the entire team to the forefront of technology.



六大系列 Six Series



冲压系列 Stamping series



管件系列 Pipe fittings series



橡胶塑料系列 Rubber and plastic series



模具检具夹具系列 Mold inspection fixture series



CCB仪表横梁总成/冲压件焊接总成
CCB instrument crossbeam assembly/
stamping welding assembly



高压油管系列
High pressure oil pipe series

■ 冲压系列 Stamping series

■ 神龙汽车 DPCA (DONGFENG PEUGEOT CITROEN AUTOMOBILE COMPANY)



大型冲压件-冲压件四门两盖系列
Large Stamped Parts - Stamped Parts Four Doors
and Two Covers Series

■ 东风本田 DONGFENG HONDA



左后门内板
Left rear door inner
panel



右后门内板
Right rear door inner
panel

■ 三一重工 SANY (SANY HEAVY INDUSTRY CO., LTD.)



门板
Door panel

■ 冲压系列 Stamping series

■ 东风岚图 VOYAH



小型冲压件-高强钢拼焊系列
Small stamping parts - high-strength steel splicing welding series

■ 东风猛士 M-TERRAIN

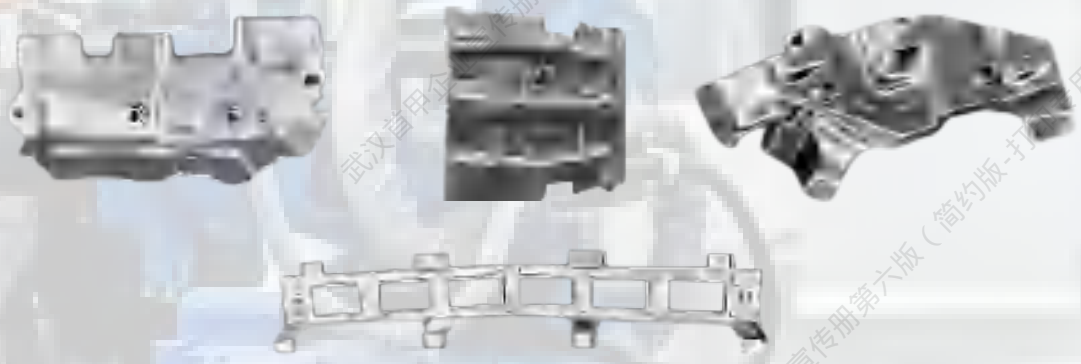

小型冲压件-铝合金板材系列
Small Stamped Parts - Aluminum Alloy Sheet Series

■ 东风乘用车 DONGFENG MOTOR



小型冲压件-板材系列
Small stamping parts - sheet metal series

■ 通用汽车 GM (GENERAL MOTORS COMPANY)

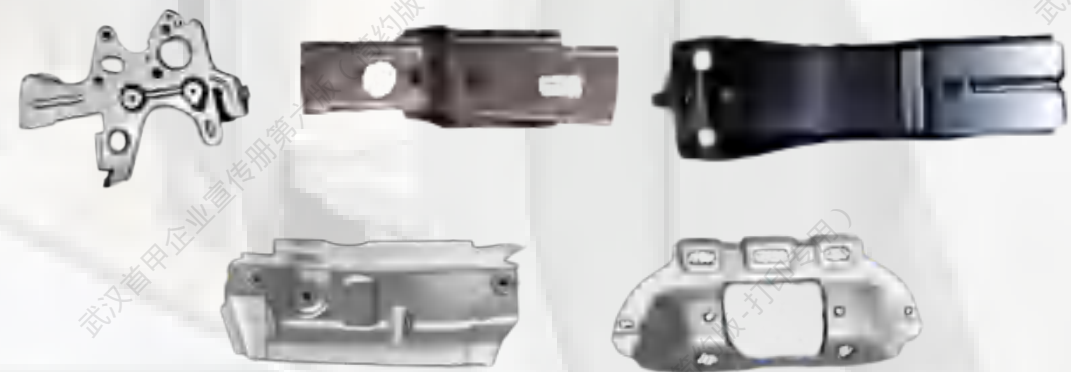

小型冲压件-盖板系列
Small Stamped Parts - Cover Plate Series

■ 管件系列 Pipe fittings series

■ 管类产品 Pipe products



管类品种齐全，直径16-80mm钢管均可生产
壁厚2.5-75mm，长度支持客户定制

The variety of pipes is complete, and steel pipes with a diameter of 16-80mm can be produced
Wall thickness 2.5-75mm, length supports customer customization



管子直径16-260mm，壁厚 ≤ 10 mm。年产量6万吨
具备5条高频直缝焊管生产线。

Pipe diameter 16-260mm, wall thickness ≤ 10 mm. The annual output is 60,000 tons
With 5 high frequency straight seam welded pipe production line.



传动轴直径89-254mm
厚度 ≤ 10 mm都可以定制
Drive shaft diameter 89-254mm
Customizable for thicknesses ≤ 10 mm

■ 东风乘用车 DONGFENG MOTOR



弯管产品-E形管系列
Bended pipe products - E-shaped pipe series

■ 东风延峰 YANFENG

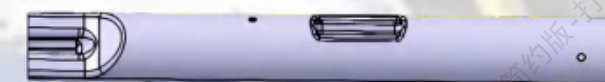

弯管产品-排气管
Bended pipe products - exhaust pipes

■ 橡胶塑料系列 Rubber and plastic series

■ 垫环-中间支撑

Backing ring - middle support



橡胶塑料系列-钢制管法兰用金属垫环（直径50-100mm）
Rubber and plastic series - Metal gasket rings for steel pipe flanges
(diameter 50-100mm)

■ 波纹管 Corrugated pipe



橡胶塑料系列-机床波纹管（直径13-400mm）
Rubber and plastic series - Machine tool corrugated pipe
(diameter 13-400mm)

■ 硅胶产品 Silicone products



硅胶产品-沟槽管件（螺纹式、异径式等）直径75-115mm均可生产，支持客户定制
Silicone products - groove fittings (threaded, reducing, etc.) with a diameter of
75-115mm can be produced, supporting customer customization

■ 模具检具夹具系列 Mold inspection fixture series

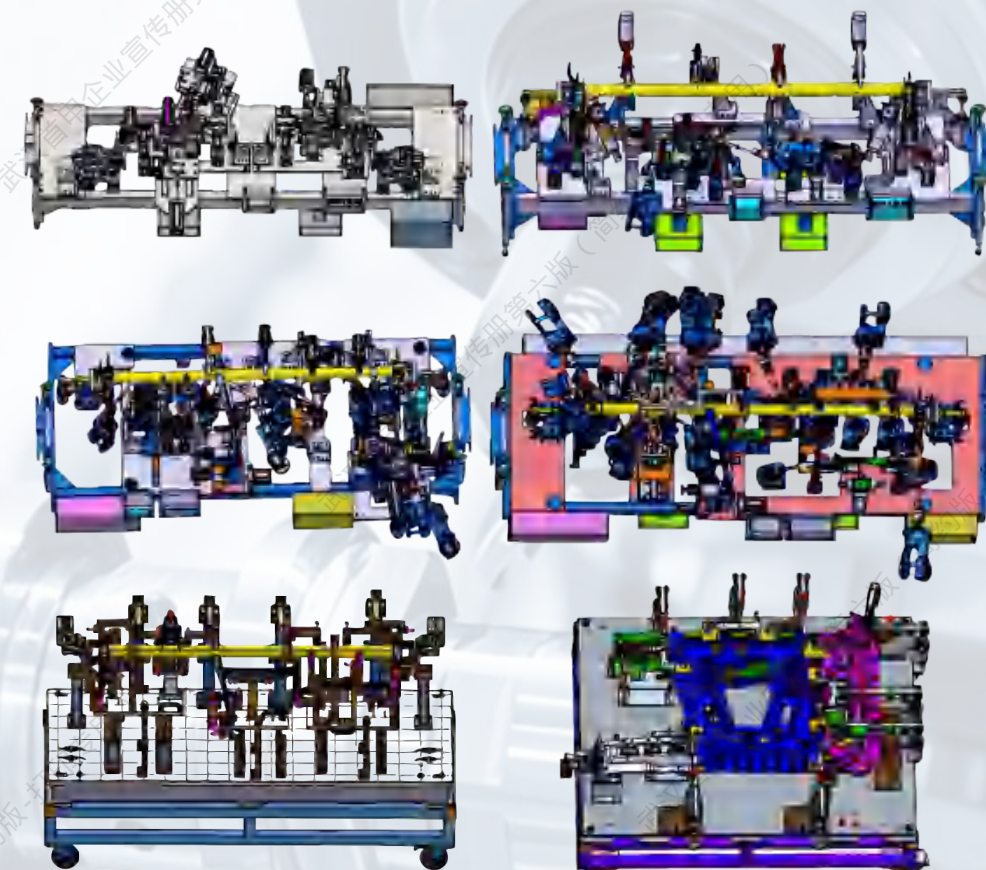

检具-汽车骨架零件总成常用检具模型
Inspection Tools - Common Inspection Tool Models for Automotive Skeleton
Parts Assembly



检具-汽车骨架零件总成检具实拍，生产能力可达每年1000套
The production capacity of the inspection tool for automotive frame parts
assembly can reach 1000 sets per year

■ CCB仪表横梁总成系列
CCB instrument crossbeam assembly series

■ 东风岚图/东风猛士
VOYAH/M-TERRAIN



焊接总成零件系列
Welding assembly parts series

■ 长城汽车 GREAT WALL



CCB仪表横梁总成零件系列
CCB Instrument Beam Assembly Parts Series

■ 模具检具夹具系列
Mold inspection fixture series

■ 东风乘用车
DONGFENG MOTOR



CCB仪表横梁总成模型及实拍
CCB instrument crossbeam assembly model and actual photos

■ 威马汽车 WELTMEISTER



焊接机器人展示
Welding robot display

■ 高压油管系列 High pressure oil pipe series

■ 聚四氟乙烯高温软管 Polytetrafluoroethylene high-temperature hose



可生产直径13-38mm聚四氟乙烯高温软管
0.1-6mm壁厚，长度支持客户定制

Can produce high-temperature polytetrafluoroethylene hoses with a diameter of 13-38mm 0.1-6mm wall thickness, length supports customer customization

■ 耐高温动转油管 High temperature resistant rotary oil pipe



高压油管系列-耐高温动转油管 内径4-25mm

High temperature resistant dynamic rotary oil pipe, Inner diameter 4-25mm

自动化车间 Automated Workshop

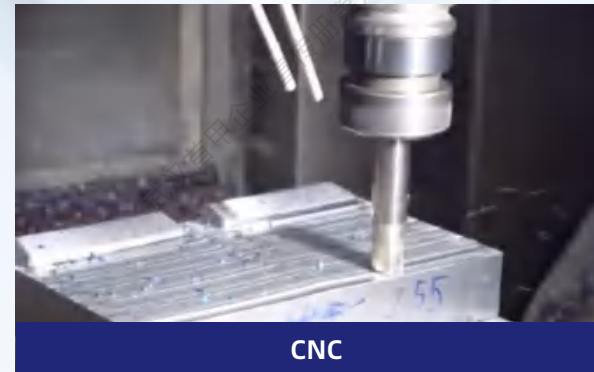

CNC

"CNC" 是英文 Computerized Numerical Control (计算机数字化控制) 的缩写。数控系统包括: 数控装置、可编程控制器、主轴驱动器及进给装置等部分。数控机床是机、电、液、气、光高度一体化的产品。数控技术及装备是发展新兴高新技术产业和尖端工业的使能技术和最基本的装备。世界各国信息产业、生物产业、航空、航天等国防工业广泛采用数控技术, 以提高制造能力和水平, 提高对市场的适应能力和竞争能力。

"CNC" is an abbreviation for Computerized Numerical Control in English. The numerical control system includes: numerical control device, programmable controller, spindle driver, and feed device. Numerical control machine tool is a highly integrated product of machine, electricity, fluid, gas, and light. Numerical control technology and equipment are the enabling technologies and basic equipment for the development of emerging high-tech industries and cutting-edge industries. CNC technology is widely used in defense industries such as information, biotechnology, aviation, and aerospace around the world to improve manufacturing capabilities and levels, enhance market adaptability and competitiveness.



机械手 Mechanical arm

机械手是一种能模仿人手和臂的某些动作功能, 用以按固定程序抓取、搬运物件或操作工具的自动操作装置。机械手是近几十年发展起来的一种高科技自动生产设备, 作业的准确性和环境中完成作业的能力。机械手主要由执行机构、驱动机构和控制系统三大部分组成。机械手在锻造工业中的应用能进一步发展锻造设备的生产能力, 改善热、累等劳动条件。

A robotic arm is an automatic operating device that can mimic certain movement functions of human hands and arms, used to grasp, move objects or operate tools according to a fixed program. Robot arm is a high-tech automatic production equipment that has developed in recent decades, with the accuracy of operations and the ability to complete tasks in the environment. The robotic arm mainly consists of three parts: the actuator, the driving mechanism, and the control system. The application of robotic arms in the forging industry can further develop the production capacity of forging equipment and improve working conditions such as heat and fatigue.



二氧化碳气体保护焊 Carbon dioxide gas shielded welding

二氧化碳气体保护焊是焊接方法中的一种, 是以二氧化碳气为保护气体, 进行焊接的方法。优势: 1. 焊接成本低。其成本只有埋弧焊、焊条电弧焊的40~50%。2. 生产效率高。其生产率是焊条电弧焊的1~4倍。3. 操作简便。明弧, 对工件厚度不限, 可进行全位置焊接而且可以向下焊接。4. 焊缝抗裂性能高。焊缝低氢且含氮量也较少。5. 焊后变形较小。角变形为千分之五, 不平度只有千分之三。6. 焊接飞溅小。当采用超低碳合金焊丝或药芯焊丝, 或在CO2中加入Ar, 都可以降低焊接飞溅。

Carbon dioxide gas shielded welding is a welding method that uses carbon dioxide gas as the shielding gas for welding. Advantages: 1. Low welding cost. Its cost is only 40-50% of that of submerged arc welding and electrode arc welding. 2. High production efficiency. Its productivity is 1-4 times that of electrode arc welding. 3. Easy to operate. Bright arc, with no limit on the thickness of the workpiece, can be welded in all positions and can be welded downwards. 4. The weld seam has high crack resistance performance. The weld seam has low hydrogen and low nitrogen content. 5. The deformation after welding is relatively small. The angular deformation is 0.5%, and the unevenness is only 0.3%. 6. Welding spatter is small. When using ultra-low carbon alloy welding wire or flux cored welding wire, or adding Ar to CO2, welding spatter can be reduced.



悬点焊 Hanging spot welding

悬挂式点焊机简称悬挂焊机, 是电阻点焊的一种。优势: 1. 悬挂式点焊机气路系统通径大, 再配以进口气动元件, 使焊钳动作快捷, 提高了生产效率。2. 焊接时, 加热时间短, 热量集中, 无电弧、无火花飞溅、无焊渣、无熔焊堆积、焊件无热变形。加之焊机创新后, 气路系统通径增大, 因此不仅焊接生产率高, 而且能耗低(节电72.3%), 焊件外观美, 质量好。3. 焊接是利用电阻热与机械力的恰当配合完成的, 所以能获得焊件焊核的高强度优质焊点。

Suspension spot welding machine, abbreviated as suspension welding machine, is a type of resistance welding spot welding. Advantages: 1. The hanging spot welding machine has a large gas path system and is equipped with imported pneumatic components, making the welding pliers move quickly and improving production efficiency. When welding, the heating time is short, the heat is concentrated, there is no arc, no spark splashing, no welding slag, no fusion welding accumulation, and no thermal deformation of the welded part. In addition, with the innovation of the welding machine, the diameter of the gas path system has increased, resulting in not only high welding productivity but also low energy consumption (72.3% electricity savings), beautiful appearance and good quality of the welded parts. 3. Welding is completed through the appropriate combination of resistance heat and mechanical force, so it can obtain high-strength and high-quality solder joints with welded nuggets.

材料科技 Material science and technology



传动轴万向节叉
Drive shaft universal joint fork



推力杆球头
Thrust rod ball head



铝锻涡旋盘
Aluminum forged scroll disk



铝锻转向节
Forged aluminum steering knuckles



双室铝合金锻前加热炉
控温精度: $\pm 1^\circ\text{C}$
两室交替使用, 提高设备效率
Double chamber aluminum alloy pre-forging furnace
Temperature control accuracy: $\pm 1^\circ\text{C}$
Two rooms are used alternately to improve equipment efficiency



2200吨六向锻造波压机
2200 tons six-way forging wave press



立式铝合金固熔炉
控温精度: $\pm 1^\circ\text{C}$
淬火转移时间 < 15秒
Vertical aluminum alloy solidification furnace
Temperature control accuracy: $\pm 1^\circ\text{C}$
Quenching transfer time < 15 seconds

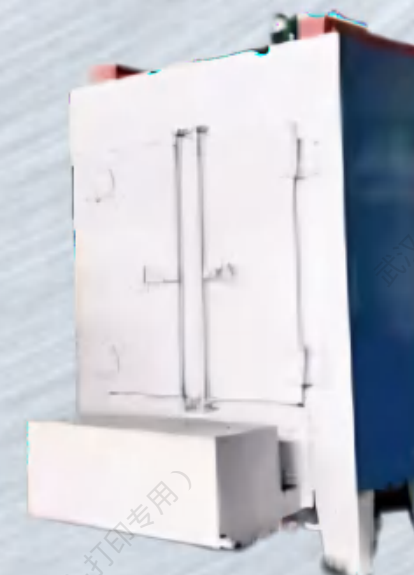

台车式时效炉
控温精度: $\pm 1^\circ\text{C}$
额定装炉量 1500 Kg
Trolley aging furnace
Temperature control accuracy: $\pm 1^\circ\text{C}$
Rated furnace capacity 1500 Kg

智慧工厂 Smart Factory

首甲集团的发展也离不开对智能技术的深度应用。随着公司规模的扩大，首甲集团采用数字化技术，将大量创新技术优势应用至工厂车间，精准采用诸如工艺设计、应用软件、机械设计和激光抓取等技术，对首甲集团的大型制造设备进行迭代，全面建设数字化生产车间及流程。

The development of the first Group is also inseparable from the in-depth application of intelligent technology. With the expansion of the scale of the company, the First Group adopts digital technology, applying a large number of innovative technological advantages to the factory floor, accurately using technologies such as process design, application software, mechanical design and laser grasp, to iterate on the large manufacturing equipment of the First Group, and comprehensively build digital production workshops and processes.

数字化 Digitization



智能化 Intelligence

自动化 Automation

设备能力 Equipment Capabilities

■ 生产设备 Production equipment



焊接线 Welding line

点焊、焊接机器人及激光拼接机器人共20台，每台机器人可实现每分钟60-120mm长度的焊接，可实现螺母碰焊、CCB总成CO₂焊接及SCOO前梁上板拼焊，适用于汽车、摩托车、工程机械、铁路机车等大批量零件生产。There are a total of 20 spot welding lines, welding robots, and laser splicing robots, each capable of welding 60-120mm in length per minute. They can achieve nut butt welding, CCB assembly CO₂ welding, and SCOO front beam upper plate splicing welding, suitable for mass production of parts such as automobiles, motorcycles, engineering machinery, and railway locomotives.



5条高频直缝焊管生产线
5 high-frequency straight seam welded pipe production lines

5条高频直缝焊管生产线，直径16-254mm、厚度≤10mm钢管均可以生产，产能可实现钢管年产量1.2万吨，年产值超过3万元。Five high-frequency straight seam welded pipe production lines can produce steel pipes with a diameter of 16-254mm and a thickness of ≤ 10mm. The production capacity can achieve an annual output of 12000 tons of steel pipes and an annual output value of over 30000 yuan.



63T-400T冲压生产线
63T-400T stamping production line

拥有400T压力机 5台、250T压力机 6台、160T压力机 12台、125T压力机 3台、110T压力机12台、100T压力机 8台、80T压力机 5台、63T压力机 4台，可实现同等类型产品8条线同时工作。We have 5 400T press machines, 6 250T press machines, 12 160T press machines, 3 125T press machines, 12 110T press machines, 8 100T press machines, 5 80T press machines, and 4 63T press machines, which can achieve simultaneous operation of 8 lines of the same type of products.



冲压-400T-2000T冲压生产线两条
Two stamping production lines for stamping -400T-2000T

适用于中大型冲压件，共9台。
Suitable for medium and large stamping parts, with a total of 9 units.



冲压模具存放 Storage of stamping molds



冲压设备-管件类设备
Stamping equipment - Pipe fittings equipment

切管机、倒角机、缩管机及弯管机共17台，适用于管件切断、下料、缩扩口、弯曲、平端头及去毛刺。
There are a total of 17 pipe cutting machines, chamfering machines, pipe shrinking machines, and pipe bending machines, suitable for pipe cutting, cutting, expanding, bending, flat end and deburring.

■ 设备能力 Equipment capability



HLTD-153三维五轴全自动激光切割机一台
One HLTD-153 three-dimensional five axis fully automatic laser cutting machine

适用于汽车覆盖件、乘用车热成形钢构件以及产品异形轮廓的快速、高精度切割加工。
Suitable for fast and high-precision cutting and processing of automotive panels, hot formed steel components for passenger cars, and irregular contours of products.



三维六轴激光切割机一台
One three-dimensional six axis laser cutting machine

适用于汽车覆盖件、乘用车热成形钢构件以及产品异形轮廓的快速、高精度切割加工。
Suitable for fast and high-precision cutting and processing of automotive panels, hot formed steel components for passenger cars, and irregular contours of products.



OFFP-B敞开式光纤激光切割机一台
One OFFP-B open type fiber laser cutting machine

适用于产品异形轮廓的快速、高精度切割加工。
Suitable for fast and high-precision cutting and processing of product irregular contours.

■ 设备能力 Equipment capability



大冲生产线 Dachong production line

配置400T-800T生产线4台、800T-1600T生产线4台、2000T油压机一台，年产量可实现1000万冲次，适用于底盘类、车身类、高强度板及其它大型冲压件零件。
Equipped with 4 400T-800T production lines, 4 800T-1600T production lines, and 1 2000T hydraulic press, the annual output can achieve 10 million strokes, suitable for chassis, body, high-strength plates, and other large stamping parts.



小冲生产线 Small punch production line

配置63T-400T共55台，配置2台700二合一、6台500二合一、3台400二合一送料机，可实现同等类型产品8条线同时工作，年产量可实现1.05亿冲次，适用于CCB横梁支架类、车身类、高强度板及其它中型、小型冲压件零件。
Equipped with a total of 55 units of 63T-400T, including 2 700 2-in-1, 6 500 2-in-1, and 3 400 2-in-1 feeders, it can achieve simultaneous operation of 8 lines of the same type of product, with an annual output of 105 million strokes. It is suitable for CCB crossbeam supports, vehicle bodies, high-strength plates, and other medium and small stamping parts.



机器人焊接线 Robot welding line

配置焊接机器人12台，激光拼焊机器人2台，点焊线6台。每台机器人可实现每分钟60-120mm长度的焊接，适用于汽车、摩托车、工程机械、铁路机车等大批量零件生产。
Configure 12 welding robots, 2 laser welding robots, and 6 spot welding lines. Each robot can achieve welding with a length of 60-120mm per minute, suitable for mass production of parts such as automobiles, motorcycles, construction machinery, and railway locomotives.



CNC加工中心T-40L实拍图（共4台）
Actual photo of CNC machining center T-40L (4 units in total)

适用于中型模具的加工。
Suitable for processing medium-sized molds.

■ 设备能力 Equipment capability



CNC加工中心大型加工中心T1420（共2台）
CNC machining center large machining center T1420 (2 units in total)

适用于中大型模具的加工。
Suitable for processing medium to large molds.



CNC加工中心T11G实拍图（共10台）
Actual photos of CNC machining center T11G (10 units in total)

适用于中小型模具的加工。
Suitable for surface grinding of large molds.



慢走丝RX853F Slow wire RX853F

适用于精密冲头及异形模控。
Suitable for precision punch and irregular mold control.



龙门磨床（共6台）Gantry grinder (6 units in total)

适用于大型模具表面研磨。
Suitable for surface grinding of large molds.



铣钻床-台湾SHCH-97US（共4台）
Milling and drilling machine - Taiwan SHCH-97US (4 units in total)

适用于各类模具零件的加工。
Suitable for processing various types of mold parts.



铣钻床-摇臂钻床（共4台）
Milling and drilling machine - Rocker arm drilling machine (4 units in total)

适用于磨具零件钻孔攻丝。
Suitable for drilling and tapping of grinding tool parts.

工程能力 Equipment Capabilities

集团具有完整的工程开发能力，同时汇聚各方面精英至开发中心。我们的项目开发中心有产品开发工程师26人、模具设计工程18人、夹具检具设计工程师6人、产品工程师1人及材料工程师1人。

The group has complete engineering development capabilities, and at the same time brings together elites from all walks of life to the development center. Our project development center has 26 product development engineers, 18 mold design engineers, 6 fixture and fixture design engineers, 1 product engineer and 1 material engineer.



■ 工程能力 Engineering capability

■ CAE模拟分析 CAE simulation analysis



开发中心采用CAE软件进行动力学分析、静态结构分析及动态分析
将其应用至材料制作的运动仿真、材料仿真及工艺仿真
The development center uses CAE software for dynamic analysis, static structural analysis, and dynamic analysis
Applying it to motion simulation, material simulation, and process simulation in material manufacturing

■ 级进模系列 Progressive Mold Series



生产能力可达每年300套
Production capacity can reach 300 sets per year

■ 工程能力 Engineering capability

■ 单工序及铸造模

Single process and casting mold



生产力可达每年1000套

Productivity can reach up to 1000 sets per year

■ 检测设备 Detection equipment



冲压检测-三坐标共3台
用于产品工装测量
Stamping inspection - 3 units in total in three coordinates
Used for product tooling measurement

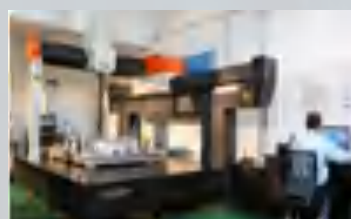

万能试验机1台
适用于材料物理性能检测
1 universal testing machine
Suitable for testing the physical properties of materials

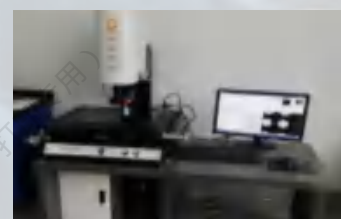

二次元投影仪1台
适用于冲压件尺寸测量
One anime projector
Suitable for measuring dimensions of stamped parts



盐雾试验机
Salt spray testing machine



金相切割机
Metallographic cutting machine



焊接检测-金相抛光机
共4台, 用于焊点破坏检查
Welding Inspection - Metallographic Polishing Machine
4 units in total, used for inspection of solder joint damage

■ 工程能力 Engineering capability

■ 标准化的过程质量管理体系

Standardized process quality management system

首甲集团具有完备且标准的质量管理体系。以制管工艺为例, 我们在生产初期就会进行详细的资材检验, 将质量不过关的资材剔除, 保留完全符合规定的材料入库并进行制管、冲压和焊接工序。生产流程结束后, 产品需要再次经过两道严密的检测流程才能出货, 出货后我们也会保留产品的样本, 对如何再次提升产品品质进行深度研发, 力求将最好的产品带给每一位客户。

Shoujia Group has a comprehensive and standardized quality management system. Taking the pipe making process as an example, we conduct detailed material inspections in the early stages of production, screen out materials with poor quality, retain materials that fully comply with regulations, and carry out pipe making, stamping, and welding processes. After the production process is completed, the product needs to go through two rigorous testing processes before it can be shipped. After shipment, we will also retain product samples and conduct in-depth research and development on how to further improve product quality, striving to bring the best product to every customer.



我们的优势 Our Advantages

■ 价值链优势 Value chain advantage

首甲集团拥有自己专属的工业园，集制管、弯管、冲压、焊接一条龙生产，相较于市面其他公司，可以更有效地减少客户在产品方面的物流、仓储、管理成本。Shoujia Group has its own exclusive industrial park, which integrates pipe manufacturing, bending, stamping, and welding in a one-stop production process. Compared with other companies in the market, it can more effectively reduce logistics, warehousing, and management costs for customers in terms of products.

■ 品质优势 Quality advantage

首甲集团具备标准的过程质量管理体系、各种产品的治具等优良检测设备以及精密的管理过程，专业的技术人员操作确保了每个产品的质量。Shoujia Group has a full value chain of independent design, development, and processing of molds, gauges, and fixtures, with a complete engineering development center to reduce development risks and provide customers with the highest quality technical experience.

■ 客户关切 Customer concerns

首甲集团以客户的需求为己任，能够迅速清楚地识别客户要求，我们会为每一位客户提供最充分、最适合您的解决方案。Shoujia Group takes customer needs as its responsibility and can quickly and clearly identify customer requirements. We will provide the most comprehensive and suitable solution for each customer.

■ 一站式服务 One-stop service

首甲集团能够为客户提供周到便捷的一站式服务，在产品成交后会提供交付安装、调试、验收、培训以及完整的售后服务，与客户实现合作共赢。Shoujia Group can provide customers with thoughtful and convenient one-stop services. After the product is sold, it will provide delivery, installation, debugging, acceptance, training, and complete after-sales service to achieve win-win cooperation with customers.

■ 技术优势 Technical advantages

首甲集团同时具备模具、检具、夹具自主设计、开发、加工的全价值链，配套拥有完整的工程开发中心，以此降低开发风险，同时带给客户最优质的技术体验。Shoujia Group has a full value chain of independent design, development, and processing of molds, gauges, and fixtures, with a complete engineering development center to reduce development risks and provide customers with the highest quality technical experience.

■ 国际视野 International perspective

首甲集团与各地区供应商展开密切合作，力求把行业最先进的视野带给客户，让客户充分感受集团在技术方面的全新领先视角。Shoujia Group collaborates closely with suppliers from various regions, striving to bring the most advanced industry perspective to customers and allow them to fully experience the group's new leading perspective in technology.

■ 同步开发 Synchronous development

首甲集团具有强大的协同合作意识以及可靠的供应商伙伴，能够基于客户需求，充分协调上下游各方资源，满足客户多样化的设计需求。Shoujia Group has a strong sense of collaborative cooperation and reliable supplier partners, which can fully coordinate upstream and downstream resources based on customer needs, and meet the diverse design needs of customers.

为客户提供一站式服务 Provide customers with one-stop services

■ 公司理念 Company philosophy

客户至上 质量第一

Customer First, Quality First

技术领先 合作共赢

Leading technology, win-win cooperation